

**GREEN INDICATES LOTS HAVE BEEN NOMINATED**

*FRONTIER SUBDIVISION*  
 LOTS 2, 3, AND 4 OF SECTION 16, AND NE1/4 OF SECTION 21, RESURVEY,  
 TOWNSHIP 52 NORTH, RANGE 93 WEST, 6TH P.M.  
 BIG HORN COUNTY, GREYBULL, WY



**LEGEND**

NEW LOT LINE	———
EXISTING BOUNDARY	———
RIGHT-OF-WAY LINE	- - - - -
NEW EASEMENT LINE	- · - · -
FOUND BRASS CAP	●
FOUND ALUMINUM CAP	●
SET 5/8"x24" REBAR WITH 2 1/2" ALUMINUM CAP	○
MEASURED DATA	N88°27'37"W-3959.64'
SUBDIVISION BOUNDARY MEASURED DATA	N88°27'50"W-2638.97'

**LEGAL DESCRIPTION**  
 BEING A PARCEL OF LAND LYING WITHIN THE NE1/4 OF SECTION 21 AND LOTS 2, 3, AND 4 OF SECTION 16, RESURVEY, T.52N., R.93W., 6TH P.M., BIG HORN COUNTY WYOMING, MORE PARTICULARLY DESCRIBED AS FOLLOWS:  
 BEGINNING AT A FOUND BRASS CAP MARKING THE NE CORNER OF SAID LOT 2; THENCE S.00°33'32"W., ALONG THE EAST LINE THEREOF, 1679.42 FEET, TO A FOUND BRASS CAP MARKING THE SE CORNER OF SAID LOT 2; THENCE S.00°36'18"W., ALONG THE EAST LINE OF SAID SECTION 21 883.28 FEET, TO A 2 1/2" ALUMINUM CAP SET THIS SURVEY; THENCE N.88°27'50"W., 2638.97 FEET, TO A 2 1/2" ALUMINUM CAP SET THIS SURVEY; THENCE N.00°35'09"E., 842.74 FEET, TO A FOUND ALUMINUM CAP MARKING THE S1/4 CORNER OF SAID SECTION 16; THENCE N.89°20'39"W., 1319.45 FEET, TO A FOUND ALUMINUM CAP MARKING THE SW CORNER OF SAID LOT 4; THENCE N.00°32'08"E., ALONG THE WEST LINE THEREOF, 1740.51 FEET, TO A FOUND ALUMINUM CAP MARKING THE NW CORNER OF SAID LOT 4; THENCE S.88°27'37"E., 3959.64 FEET, MORE OR LESS, TO THE POINT OF BEGINNING.  
 CONTAINING 207.78 ACRES, MORE OR LESS.

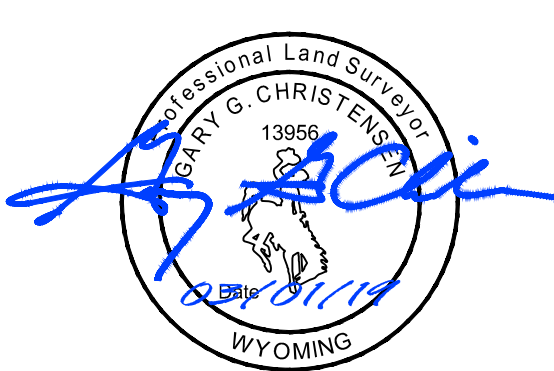

GARY G. CHRISTENSEN  
 WYOMING PLS 13956

<b>T-O ENGINEERS</b>		
<b>FINAL PLAT</b>		
FRONTIER SUBDIVISION WITHIN LOTS 2, 3, AND 4 OF SECTION 16, AND NE1/4 OF SECTION 21, RESURVEY, T.52N., R.93W., 6TH P.M., BIG HORN COUNTY, WYOMING TOWN OF GREYBULL, WY		
PROJECT NO: 181229	SURVEYED BY: PJD	REVIEWED BY: GGC
DATE SURVEYED: 10/26/17	DRAFTED BY: TJH	REVISION NO: 1